

ELEVATION CERTIFICATE

FEDERAL EMERGENCY MANAGEMENT AGENCY NATIONAL FLOOD INSURANCE PROGRAM

O.M.B. No 3067-0077
Expires May 31, 1993

ATTENTION: Use of this certificate does not provide a waiver of the flood insurance purchase requirement. This form is used only to provide elevation information necessary to ensure compliance with applicable community floodplain management ordinances, to determine the proper insurance premium rate, and/or to support a request for a Letter of Map Amendment or Revision (LOMA or LOMR).
Instructions for completing this form can be found on the following pages.

SECTION A PROPERTY INFORMATION		FOR INSURANCE COMPANY USE
BUILDING OWNER'S NAME Target Stores	POLICY NUMBER	
STREET ADDRESS (Including Apt., Unit, Suite and/or Bldg. Number) OR P.O. ROUTE AND BOX NUMBER 1650 East Milton Road	COMPANY NAIC NUMBER	
OTHER DESCRIPTION (Lot and Block Numbers, etc.)		
CITY Flagstaff	STATE Arizona	ZIP CODE 86001

SECTION B FLOOD INSURANCE RATE MAP (FIRM) INFORMATION

Provide the following from the proper FIRM (See Instructions):

1. COMMUNITY NUMBER	2. PANEL NUMBER	3. SUFFIX	4. DATE OF FIRM INDEX	5. FIRM ZONE	6. BASE FLOOD ELEVATION (in AO Zones, use depth)
040020	11 of 21	B	SEPT. 28, 1990 January 19, 1983	A5	6891.00

7. Indicate the elevation datum system used on the FIRM for Base Flood Elevations (BFE): NGVD '29 Other (describe on back)
8. For Zones A or V, where no BFE is provided on the FIRM, and the community has established a BFE for this building site, indicate the community's BFE: feet NGVD (or other FIRM datum—see Section B, Item 7).

SECTION C BUILDING ELEVATION INFORMATION

1. Using the Elevation Certificate Instructions, indicate the diagram number from the diagrams found on Pages 5 and 6 that best describes the subject building's reference level 1.
- 2(a). FIRM Zones A1-A30, AE, AH, and A (with BFE). The top of the reference level floor from the selected diagram is at an elevation of 6892.0 feet NGVD (or other FIRM datum—see Section B, Item 7).
- (b). FIRM Zones V1-V30, VE, and V (with BFE). The bottom of the lowest horizontal structural member of the reference level from the selected diagram is at an elevation of feet NGVD (or other FIRM datum—see Section B, Item 7).
- (c). FIRM Zone A (without BFE). The floor used as the reference level from the selected diagram is feet above or below (check one) the highest grade adjacent to the building.
- (d). FIRM Zone AO. The floor used as the reference level from the selected diagram is feet above or below (check one) the highest grade adjacent to the building. If no flood depth number is available, is the building's lowest floor (reference level) elevated in accordance with the community's floodplain management ordinance? Yes No Unknown
3. Indicate the elevation datum system used in determining the above reference level elevations: NGVD '29 Other (describe under Comments on Page 2). (NOTE: If the elevation datum used in measuring the elevations is different than that used on the FIRM [see Section B, Item 7], then convert the elevations to the datum system used on the FIRM and show the conversion equation under Comments on Page 2.)
4. Elevation reference mark used appears on FIRM: Yes No (See Instructions on Page 4)
5. The reference level elevation is based on: actual construction construction drawings
(NOTE: Use of construction drawings is only valid if the building does not yet have the reference level floor in place, in which case this certificate will only be valid for the building during the course of construction. A post-construction Elevation Certificate will be required once construction is complete.)
6. The elevation of the lowest grade immediately adjacent to the building is: 6891.5 feet NGVD (or other FIRM datum—see Section B, Item 7).

SECTION D COMMUNITY INFORMATION

1. If the community official responsible for verifying building elevations specifies that the reference level indicated in Section C, Item 1 is not the "lowest floor" as defined in the community's floodplain management ordinance, the elevation of the building's "lowest floor" as defined by the ordinance is: feet NGVD (or other FIRM datum—see Section B, Item 7).
2. Date of the start of construction or substantial improvement 12/29/93

SECTION E CERTIFICATION

This certification is to be signed by a land surveyor, engineer, or architect who is authorized by state or local law to certify elevation information when the elevation information for Zones A1-A30, AE, AH, A (with BFE), V1-V30, VE, and V (with BFE) is required. Community officials who are authorized by local law or ordinance to provide floodplain management information, may also sign the certification. In the case of Zones AO and A (without a FEMA or community issued BFE), a building official, a property owner, or an owner's representative may also sign the certification.

Reference level diagrams 6, 7 and 8 - Distinguishing Features-If the certifier is unable to certify to breakaway/non-breakaway wall, enclosure size, location of servicing equipment, area use, wall openings, or unfinished area Feature(s), then list the Feature(s) not included in the certification under Comments below. The diagram number, Section C, Item 1, must still be entered.

I certify that the information in Sections B and C on this certificate represents my best efforts to interpret the data available. I understand that any false statement may be punishable by fine or imprisonment under 18 U.S. Code, Section 1001.

CERTIFIER'S NAME		LICENSE NUMBER (or Affix Seal)		
Robert K. Landis		L.S. 15883		
TITLE	COMPANY NAME			
Vice President	The WLB Group, Inc.			
ADDRESS	CITY	STATE	ZIP	
333 East Osborn Road, Suite 380	Phoenix	Arizona	85012	
SIGNATURE	DATE	PHONE		
<i>Robert K. Landis</i>	5/17/94	(602) 279-1016		

Copies should be made of this Certificate for: 1) community official, 2) insurance agent/company, and 3) building owner.

COMMENTS: Attached is a copy of the certification letter from Kenneth A. Krenke R.L.S. 14671, dated April 15, 1994.

Basis of Elevation: A 1/2" rebar with cap, located at the northwest corner of Target Property marked "LS 7500" said elevation being 6895.62. 1929 NGVD Datum.

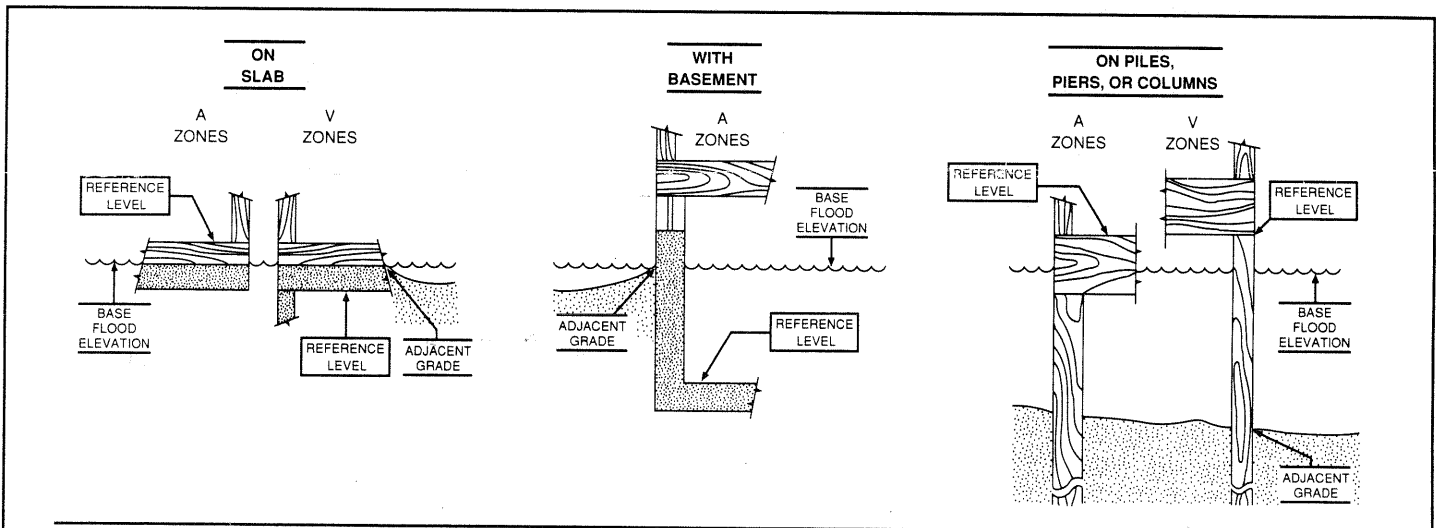
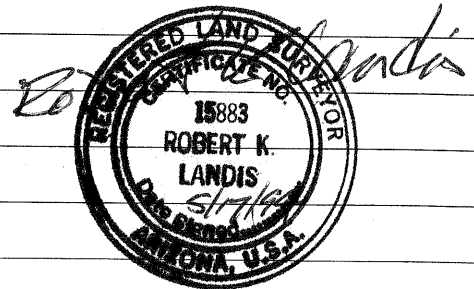

The diagrams above illustrate the points at which the elevations should be measured in A Zones and V Zones. Elevations for all A Zones should be measured at the top of the reference level floor. Elevations for all V Zones should be measured at the bottom of the lowest horizontal structural member.



April 15, 1994

Gary Prinsen
Ryan Companies
700 International Centre
900 Second Avenue South
Minneapolis, MN 55402-3387

RE: Target Store at 1650 South Milton, Flagstaff, Arizona.

Dear Mr. Prinsen,

This letter is to certify that we have inspected the completed building finish floor on April 14, 1994 and that the existing finish floor is at an elevation of 6892.00 per the engineering plans Job No. 19026 by The WLB Group, 4444 East Broadway, Tucson, AZ 85711.

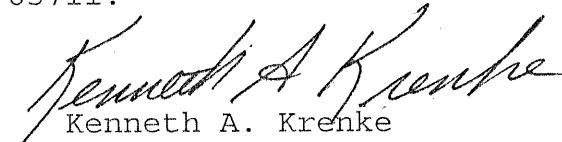
Kenneth A. Krenke
Chief Surveyor

93-085-F.



